

REVISIONS			
REV	DESCRIPTION	DATE	APPROVED
A	RELEASE FOR PRODUCTION	10-01-04	

RESOLVER CHARACTERISTICS

EXCITATION	7 VOLTS RMS
FREQUENCY	10 KHz
EXCITATION CURRENT (NOM.)	50 mA
EXCITATION POWER (NOM.)	0.2 WATT MAX.
TRANSFORMATION RATIO ($\pm 10\%$)	0.5
NULL VOLTAGE (TOTAL)	20mV MAX.
SENSITIVITY	61 mv/DEGREE
PHASE SHIFT (STATOR TO ROTOR)	2°
ERROR (MAX.)	± 15 MINUTES
ROTOR IMPEDANCE (STATOR OPEN)	105 + J170 OHMS
STATOR IMPEDANCE (ROTOR OPEN)	185 + J311 OHMS
STATOR IMPEDANCE (ROTOR SHORTED)	160 + J270 OHMS
ROTOR D.C. RESISTANCE ($\pm 10\%$)	40 OHMS
STATOR D.C. RESISTANCE ($\pm 10\%$)	77 OHMS
HI-POT BETWEEN PHASES	250V AC
WINDING TO GROUND *	1300V AC
THERMAL RATING	190°C

* 1300V rms AT 60Hz FOR 1 MINUTE BETWEEN LEADS AND THE CASE. ALL ADDITIONAL APPLICATIONS SHOULD NOT EXCEED 80% OF THIS VOLTAGE.

RESOLVER SCHEMATIC

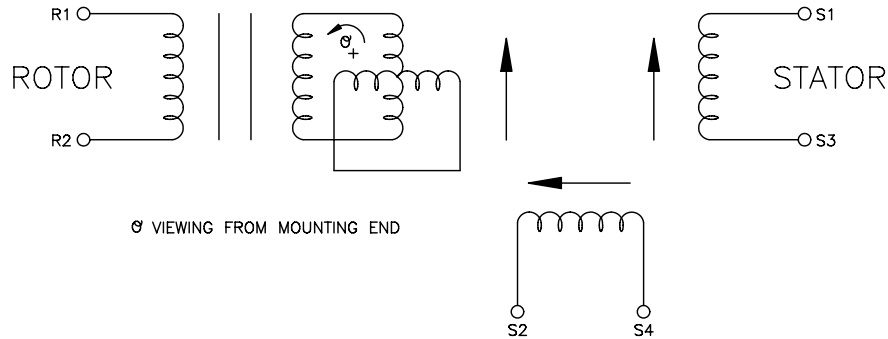

LEAD IDENTIFICATION FOR RESOLVER

R1 - RED/WHITE EXC HI	S1 - RED COS HI
R2 - BLACK/WHITE EXC LO	S2 - YELLOW SIN HI
	S3 - BLACK COS LO
	S4 - BLUE SIN LO

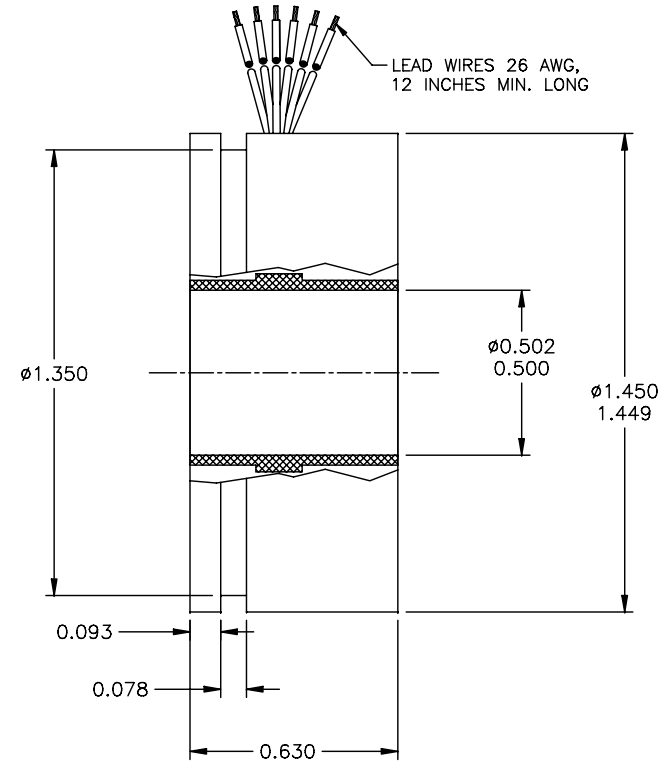

UNLESS OTHERWISE SPECIFIED DIMENSIONS ARE IN INCHES FRAC. DEC. ANGLE $\pm 1/64$.XXXXX .XXXX.005 .XX.X.01	FILE NAME 15BRX7	SOPT ELECTRICAL PRODUCTS DIVISION AURORA, ILL. 60504
	CONTRACT NO -	
	DRAWN BOSNAK	FRAMELESS RESOLVER ASSEMBLY (SIZE 15)
	DATE 10-01-04	
MAT'L	CHECK	SIZE FSCM NO
HEAT TREAT.	APPR.	B -
FINISH	ISSUED	DWG NO 15BRX7-B01-102E
		SCALE 1:1
		WEIGHT
		SHEET 1 OF 1